

HOTEL METROPOLE
GENEVE
1854

CONFERENCES BROCHURE

HOTEL METROPOLE
GENEVE
1854

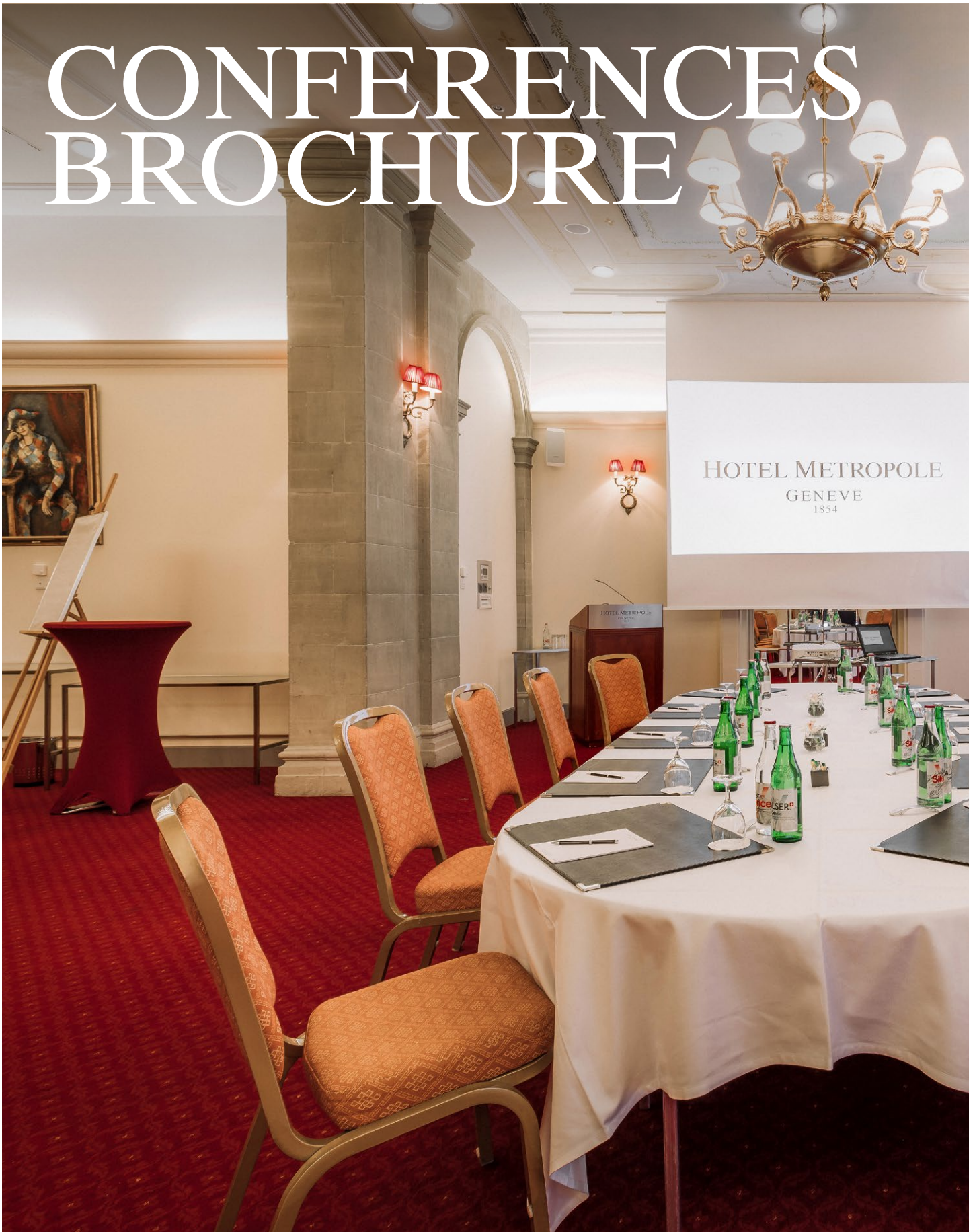

CONTENTS

MEETING ROOMS AND TECHNICAL EQUIPMENT

- Meeting room capacities 3
- AV and technical equipment 4

CONFERENCE PACKAGES

5

CONTACTS AND ACCESS

6

MEETING ROOM CAPACITIES

Meeting rooms	m ²	L (m)	W (m)	H (m)	CONFERENCE				BANQUET		
					Theatre	School	U-shape	Cluster	Round table	Boardroom	Cocktail
GROUND FLOOR											
Grand Wagner	142	22	6.4	4.1	200	90	40	84	120		200
Petit Wagner			6.4	4.1	90	60	25	42	60	25	100
Liszt	47	7	6.4	4.1	30	18	14	14	30	14	30
Arlequin	105	9	6	4.1	80	40	25	35	50	25	100
Wagner + Liszt	189	29	6.4	4.1					160		
Wagner + Liszt + Berlioz	263	40	6.4	4.1	280				200		250
Berlioz	75	11	6.4	4.1	80	50	25	35	60	25	80
Berlioz + Liszt	121	18	6.4	4.1	110	80	25	60	100	30	120
5th FLOOR											
Jura	96	11	9	2.6	70	45	25	35	60	15	80
Salève	96	11	9	2.6	70	45	25	35	60	15	80
Jura + Salève + Salon	241	32	23								250
Terrace Salève + Jura	113	13	4								120

GROUND LEVEL

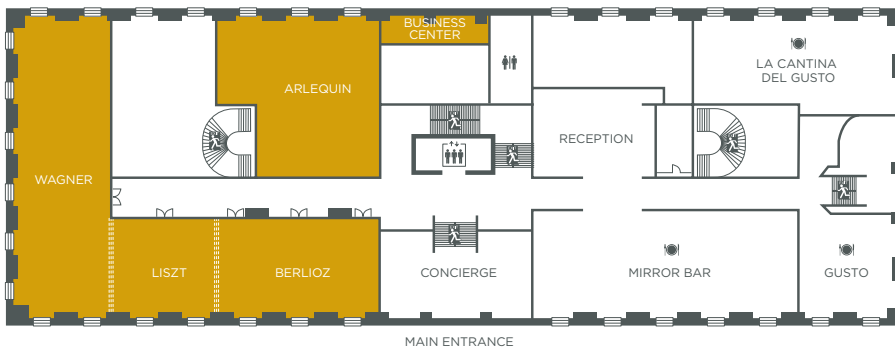

- Meeting room or ballroom
- Food & beverages outlet
- Moveable partition

LEVEL 5



AV AND TECHNICAL EQUIPMENT

VIDEO

• Video projector	CHF 300.-
• Cd player / multi-zone dvd player	CHF 100.-
• Laptop	CHF 200.-
• Lcd screen	CHF 200.-

SOUND SYSTEM

• Cordless microphone	CHF 150.-
• Head microphone	CHF 250.-

COMMUNICATION

• Conference telephone (1/2 day, calls included)	CHF 250.-
• Telephone with direct line	upon request
• High speed internet	free of charge

PRESENTATION

• Additional flipchart	CHF 30.-
• Console with microphone	free of charge
• Laser pointer	free of charge

PRINTING

• Copies 0.50/page	CHF
• More than 100 copies 0.30/page	CHF

Other equipments and services available upon request

CONFERENCE PACKAGES

Package available for 15 participants or above
Please note that for less than 15 participants, an additional room rental will apply

FULL-DAY CONFERENCE PACKAGE

CHF 140.- PER PERSON

- Plenary conference room with natural daylight and air-conditioning
- Setup of your choice with desk blotters, bloc notes, pens and candies
- AV equipment: LCD projector with screen, flip-chart
- Still and sparkling mineral water on tables during the meeting
- Welcome coffee
- Coffee break in the morning and in the afternoon
- Lunch : 3-course menu or buffet
- Mineral water, coffee and tea during lunch
- WIFI internet access
- Floral decoration

HALF-DAY CONFERENCE PACKAGE

CHF 110.- PER PERSON

- Plenary conference room with natural daylight and air-conditioning
- Setup of your choice with desk blotters, bloc notes, pens and candies
- AV equipment: LCD projector with screen, flip-chart
- Still and sparkling mineral water on tables during a meeting
- Welcome coffee
- Coffee break in the morning or in the afternoon
- Lunch : 3-course menu or buffet
- Mineral water, coffee and tea during lunch
- WIFI internet access
- Floral decoration

HOTEL METROPOLE

GENEVE
1854

CONTACTS AND ACCESS

REQUESTS WITH OR WITHOUT ACCOMMODATION

Sales departement
T +41 22 318 34 79
sales@metropole.ch

HOTEL METROPOLE GENEVE *****

Quai Général-Guisan 34
1204 Geneva · Switzerland
T +41223183200
hotel@metropole.ch
METROPOLE.CH

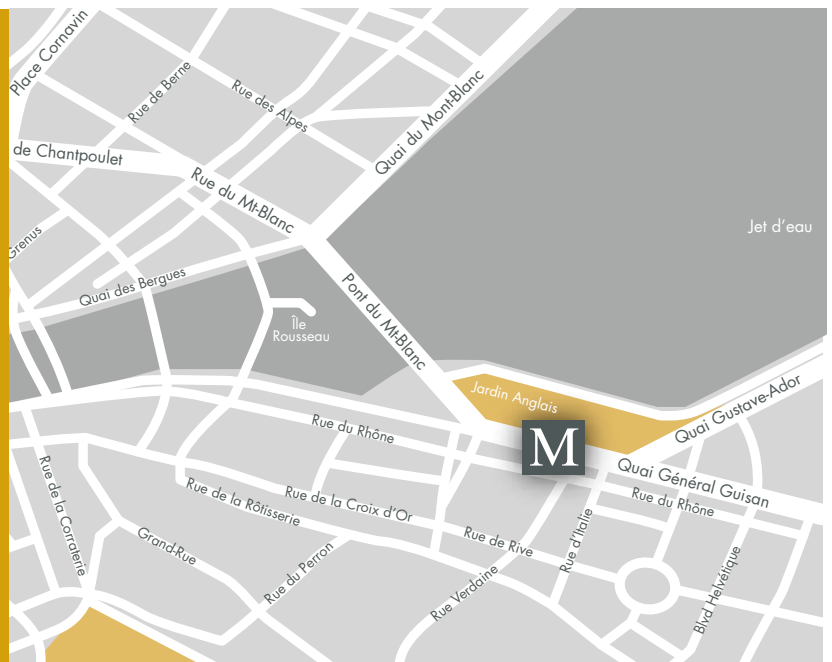

DISTANCES

Cornavin train station	1.2 km
Basel	260 km
Paris	555 km
Cointrin international airport	6.4 km
Zurich	300 km
Lyon	150 km

DIRECTIONS

From Cornavin train station

Bus 8, 9 or 25 from "place du port" to Metropole stop (10 min.)

From airport

Take the train to the Cornavin train station, then bus 8, 9 or 25 to Métropole stop (20 min), or bus 10 directly from the airport

By car

Follow Geneva center, then Evian-France.

The hotel is on the right 200m after the Mont-Blanc bridge.

Parking

Valet service. The Mont-Blanc car park is 100m from the hotel.